

## 20 180 KS0 VERIS 3-HOLE BASIN MIXER M-SIZE

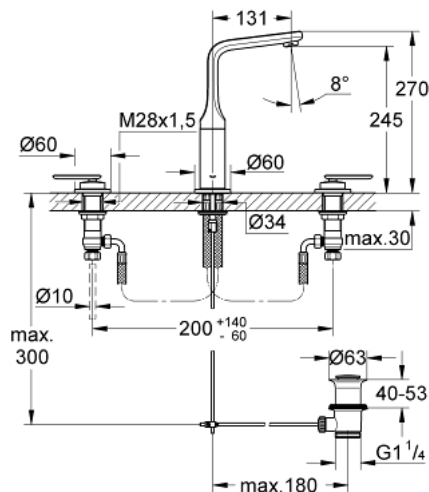

### PRODUCT DESCRIPTION

- Colour: velvet black
- ceramic headparts 1/2", 90°
- GROHE Long-Life finish
- SpeedClean Mousseur
- swivelling spout
- stop limiter
- pop-up waste set 1 1/4"
- pressure-proof, flexible connection hoses between spout and side valves
- union nut with 10.5 mm drilling



## 20 180 KS0 VERIS 3-HOLE BASIN MIXER M-SIZE

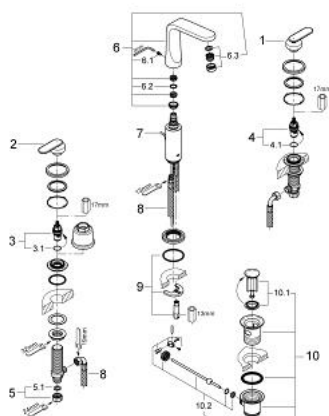

### SPARE PARTS, Jun 2009 – spareParts.validDate.now

- 1: Handle (Order-nr. 48015KS0)
- 2: Handle (Order-nr. 48016KS0)
- 3: Ceramic headpart, 1/2" (Order-nr. 45882000)
- 3.1: O-ring  $\varnothing 18.2 \times \varnothing 1.7$  (Order-nr. 0392400M)
- 4: Ceramic headpart, 1/2" (Order-nr. 45883000)
- 4.1: O-ring  $\varnothing 18.2 \times \varnothing 1.7$  (Order-nr. 0392400M)
- 5: Coupling nut 1/2" x 10.5 mm (Order-nr. 1290100M)
- 5.1: Fibre seal dia. 12x2 mm (Order-nr. 0138900M)
- 6: Spout (Order-nr. 13246KS0)
- 6.1: Set of screws (Order-nr. 46670000)
- 6.2: Sealing washer (Order-nr. 0128500M)
- 6.3: Flow straightener (Order-nr. 64447000)
- 7: Pop-up rod (Order-nr. 10769000)
- 8: Flexible hose (Order-nr. 45461000)
- 9: Shank mounting kit (Order-nr. 46671000)
- 10: Pop-up waste set 1 1/4" (Order-nr. 28910000)
- 10.1: Plug (Order-nr. 07182000)
- 10.2: Eccentric rod (Order-nr. 07052000)