

A tall, modern, chrome-finished bidet sprayer. It features a long, curved nozzle at the top, a central body with a small side handle, and two side handles at the base for mounting. The design is sleek and contemporary.

- Colour: chrome
- ceramic headparts 1/2", 90°
- GROHE Long-Life finish
- SpeedClean Mousseur
- swivelling spout
- stop limiter
- pop-up waste set 1 1/4"
- pressure-proof, flexible connection hoses between spout and side valves
- union nut with 10.5 mm drilling

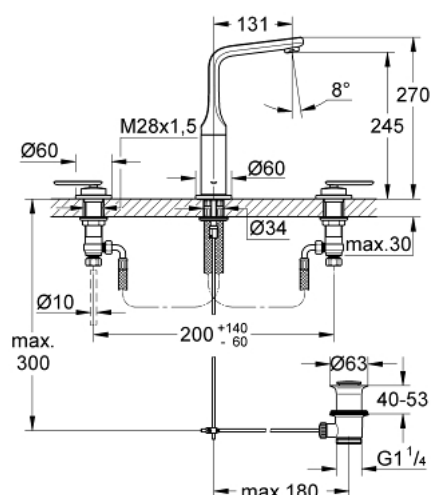

20 180 000 VERIS 3-HOLE BASIN MIXER M-SIZE

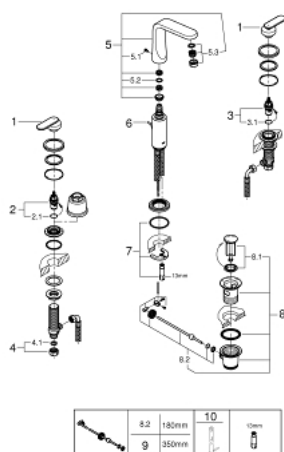

SPARE PARTS, Sep 2016 – spareParts.validDate.now

- 1: Handle pair (Order-nr. 48305000)
- 2: Ceramic headpart, 1/2" (Order-nr. 45882000)
- 2.1: O-ring $\varnothing 18.2 \times \varnothing 1.7$ (Order-nr. 0392400M)
- 3: Ceramic headpart, 1/2" (Order-nr. 45883000)
- 3.1: O-ring $\varnothing 18.2 \times \varnothing 1.7$ (Order-nr. 0392400M)
- 4: Coupling nut 1/2" x 10.5 mm (Order-nr. 1290100M)
- 4.1: Fibre seal dia. 12x2 mm (Order-nr. 0138900M)
- 5: Spout (Order-nr. 13246000)
- 5.1: Set of screws (Order-nr. 46670000)
- 5.2: Sealing washer (Order-nr. 0128500M)
- 5.3: Flow straightener (Order-nr. 64447000)
- 6: Pop-up rod (Order-nr. 46739000)
- 7: Shank mounting kit (Order-nr. 46671000)
- 8: Pop-up waste set 1 1/4" (Order-nr. 28910000)
- 8.1: Plug (Order-nr. 07182000)
- 8.2: Eccentric rod (Order-nr. 07052000)
- 9: Eccentric rod (Order-nr. 07341000)*
- 10: Mounting wrench (Order-nr. 19017000)*

* Optional accessories